

create meetings, events & functions

continue...



GUOMAN HOTELS
THE TOWER

create menu

introduction - facilities - why choose create - floor plans - additional services - contact



Please navigate through this presentation by clicking on any one of the menu buttons above

St Katharine's Dock

print - quit

www.guoman.com

A place to meet. To talk. To Create.

The Guoman Tower is unlike any hotel you've ever experienced. Which explains why our meetings and events facilities are different too.

At The Tower, we always remember whose event it is. So our facilities work around you, not vice versa. All our 24 conference rooms are designed to ensure everyone's comfortable and gets the most from their time here. And with our dedicated professional team on hand to help everything run like clockwork, it's the perfect London venue for business or private events. Whatever you've got in mind, we'll make it possible.



Butler's Wharf



[Click here to see the full version of this map on the Contact Page.](#)



A warm welcome



The Gallery

The Tower Suite

The Tower Suite comprises three individual meeting rooms, subdivided by acoustic walls to ensure total privacy. Each room is air-conditioned, offers individual control panels for lighting and is equipped with 3 phase power. The area also offers a versatile foyer with stunning views of Tower Bridge and the River Thames, which may be subdivided if required.

- Fully refurbished in 2007
- Flexible space which splits into three rooms
- Large reception area with natural daylight and views over the River Thames
- Fully air-conditioned meeting rooms
- Moveable staging and dancefloor
- In-house AV company with on-site technicians
- Three large purpose-built meeting rooms which can be used individually or as one large space
- Total of 550 square metres
- Maximum capacity of 600 guests
- Accessed through private exterior entrance
- Whole area accessible for wheelchair users



The Tower Suite



12th Floor Penthouse
Meetings & Events

12th Floor Boardroom

Flexible capacities.

Create comprises of 24 conference rooms that can be set up virtually any way you want.

For larger meetings, events, conferences and bigger get-togethers, you can choose from the impressive, versatile Tower Suite which can be arranged to hold up to 600 theatre-style, or alternatively as three rooms holding up to 200 each. There are also four large rooms, each hosting up to 50 people, four medium rooms for up to 30 as well as two small rooms, able to contain up to 20 each.

For something more formal or intimate, we also have seven Syndicate Rooms seating up to 15 people as well as The Boardroom, hosting up to 16.

And of course, you can have any number of rooms, in any combination, and arranged any way you like. All you have to do is ask.

[See the floorplans on the following pages](#)

next >

print - quit



12th Floor Boardroom

Teamwork.

And then there's our team. Create is different and so are they. Without exception, they're friendly, resourceful people with flair, imagination and a total commitment to making your event a success.

They have impeccable standards, unrivalled skills and knowledge, and the power to put them to work on your behalf. They can assist with all elements from setting up the audio and visual elements for a function to welcoming your delegates or guests.

So although they're on our payroll, while you're with us, they're working for you.



High speed Internet
Access available

As standard:

- High speed wireless internet access
- LCD projector and screen
- On-site audio-visual technical support
- Full on site secretarial support in our Business Centre
- Guaranteed lunch time check-in (if required)
- Comprehensive range of menu/refreshment options



Floorplans.

For details of every meeting room at The Tower, please refer to the following floorplans.

Please click on either of the floorplans below to bring up a closer view of that area.



The Tower Suite, Conference style

Tower Suite

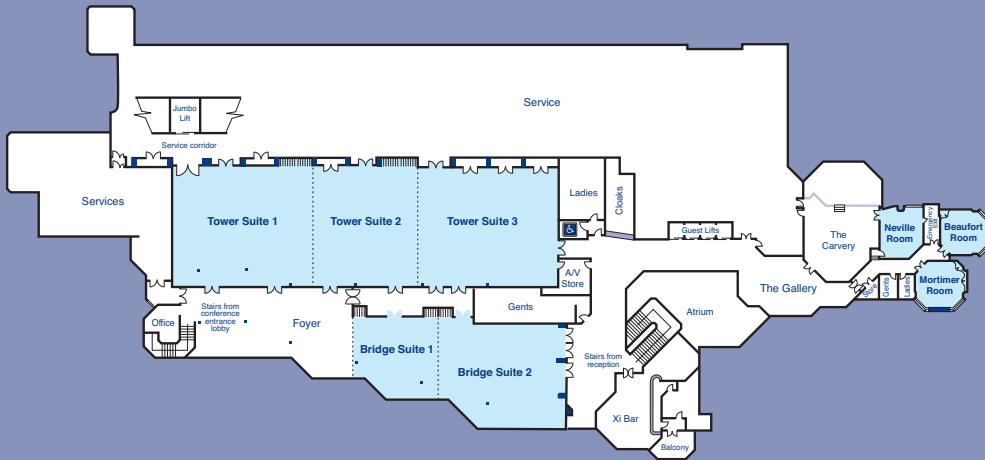

[click here](#) for floor plans

12th Floor



[click here](#) for floor plans



12th Floor



Please use this floor plan of the 12th floor to choose a meeting room. Simply roll your mouse over the rooms to bring up a detailed floor plan and technical specification of that room.



[back to main floorplan menu](#)

Nimrod Suite Specification

Floor of hotel	12th
Air Conditioning	yes
CAPACITIES	
Theatre	22
Classroom	16
Boardroom	16
Hollow Square	-
U-shape	16
Cabaret	-
Reception	-
Dinner - rounds	16
Dinner dance	-
BASIC DIMENSIONS	
Length	- metres 7.14
	- feet 23'5"
Width	- metres 5.72
	- feet 18'9"
Height	- metres 2.07
	- feet 6'9"
Area	- metres 41.00
	- feet 441
ACCESS	
Door height	- metres 1.95
	- feet 6'4"
Door width	- metres 0.72
	- feet 2'4"

Key to Symbols

- (D)** Double 13 amp socket
- (S)** Single 13 amp socket
- (TV)** TV Aerial point
- (T)** Telephone socket
- (F)** Fax/Modem socket
- (I)** ISDN2 socket
- (M)** Microphone socket
- (L)** Light switch
- (Sp)** Speaker socket
- (Dx)** 5 pin DMX socket
- (Va)** 15 pin VGA socket
- (X)** 19 pin lighting connector
- (⊗)** 16amp single phase supply
- (⊙)** 32amp single phase supply
-  Serving Surface
- (0.00)** Ceiling Height

Nimrod Suite Floorplan

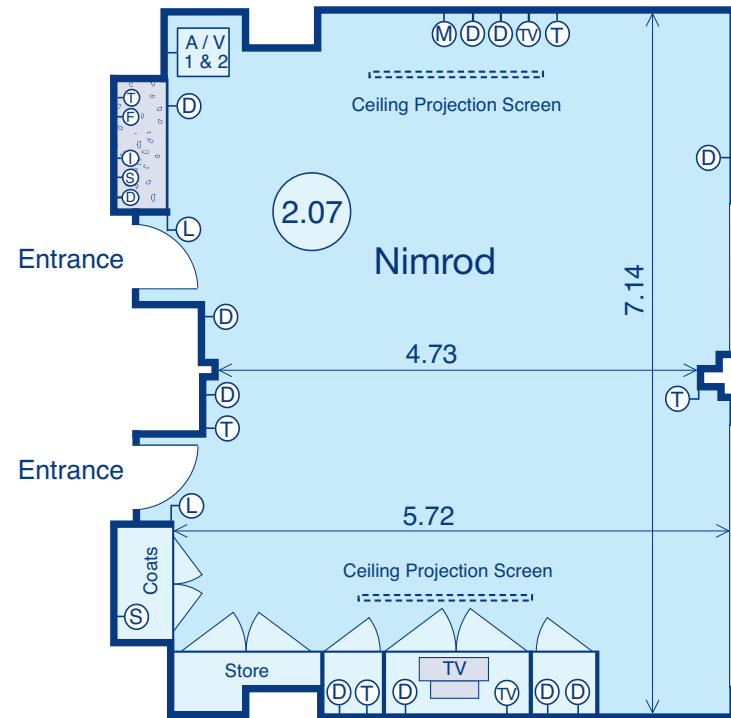

[back to 12th floor floorplan menu](#)



















[back to main floorplan menu](#)

Fearless Suite Specification

Floor of hotel	12th	
Air Conditioning	yes	
CAPACITIES		
Theatre	-	
Classroom	-	
Boardroom	14	
Hollow Square	-	
U-shape	-	
Cabaret	-	
Reception	-	
Dinner - rounds	-	
Dinner dance	-	
BASIC DIMENSIONS		
Length	- metres	7.02
	- feet	23'4"
Width	- metres	5.85
	- feet	19'3"
Height	- metres	2.07
	- feet	6'9"
Area	- metres	41.00
	- feet	441
ACCESS		
Door height	- metres	1.95
	- feet	6'4"
Door width	- metres	0.72
	- feet	2'4"

Key to Symbols

-  Double 13 amp socket
-  Single 13 amp socket
-  TV Aerial point
-  Telephone socket
-  Fax/Modem socket
-  ISDN2 socket
-  Microphone socket
-  Light switch
-  Speaker socket
-  5 pin DMX socket
-  15 pin VGA socket
-  19 pin lighting connector
-  16amp single phase supply
-  32amp single phase supply
-  Serving Surface
-  0.00 Ceiling Height

Fearless Suite Floorplan

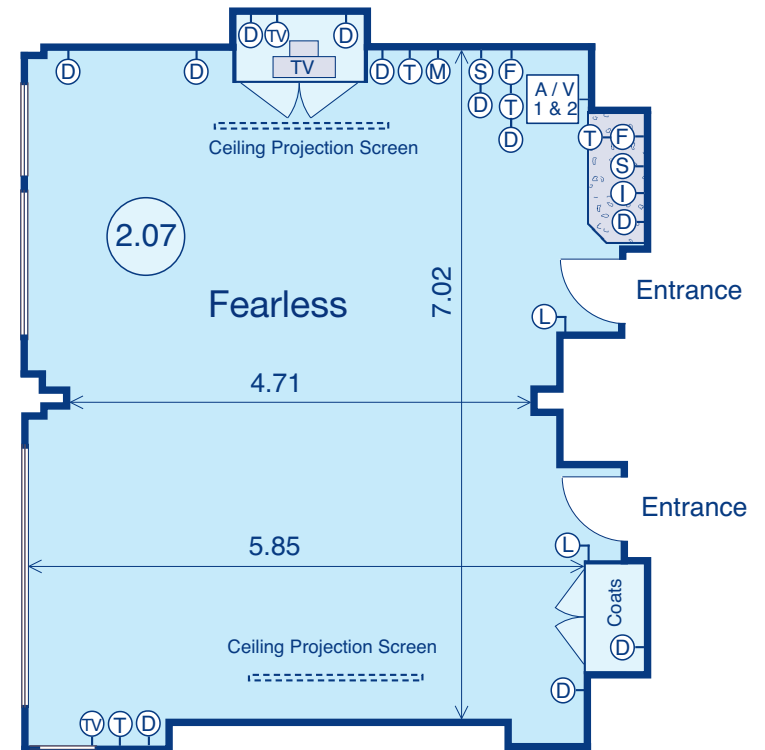

back to 12th floor
floorplan menu



back to main
floorplan menu

Great Harry Suite Specification

Floor of hotel	12th	
Air Conditioning	yes	
CAPACITIES		
Theatre	45	
Classroom	27	
Boardroom	22	
Hollow Square	-	
U-shape	24	
Cabaret	-	
Reception	-	
Dinner - rounds	28	
Dinner dance	-	
BASIC DIMENSIONS		
Length	- metres	9.40
	- feet	30'10"
Width	- metres	5.80
	- feet	19'0"
Height	- metres	2.04
	- feet	6'8"
Area	- metres	54.50
	- feet	586
ACCESS		
Door height	- metres	1.95
	- feet	6'4"
Door width	- metres	1.40
	- feet	4'8"

Key to Symbols

- (D)** Double 13 amp socket
- (S)** Single 13 amp socket
- (TV)** TV Aerial point
- (T)** Telephone socket
- (F)** Fax/Modem socket
- (I)** ISDN2 socket
- (M)** Microphone socket
- (L)** Light switch
- (Sp)** Speaker socket
- (Dx)** 5 pin DMX socket
- (Va)** 15 pin VGA socket
- (X)** 19 pin lighting connector
- (⊗)** 16amp single phase supply
- (⊙)** 32amp single phase supply
-  Serving Surface
- (0.00)** Ceiling Height

Great Harry Suite Floorplan

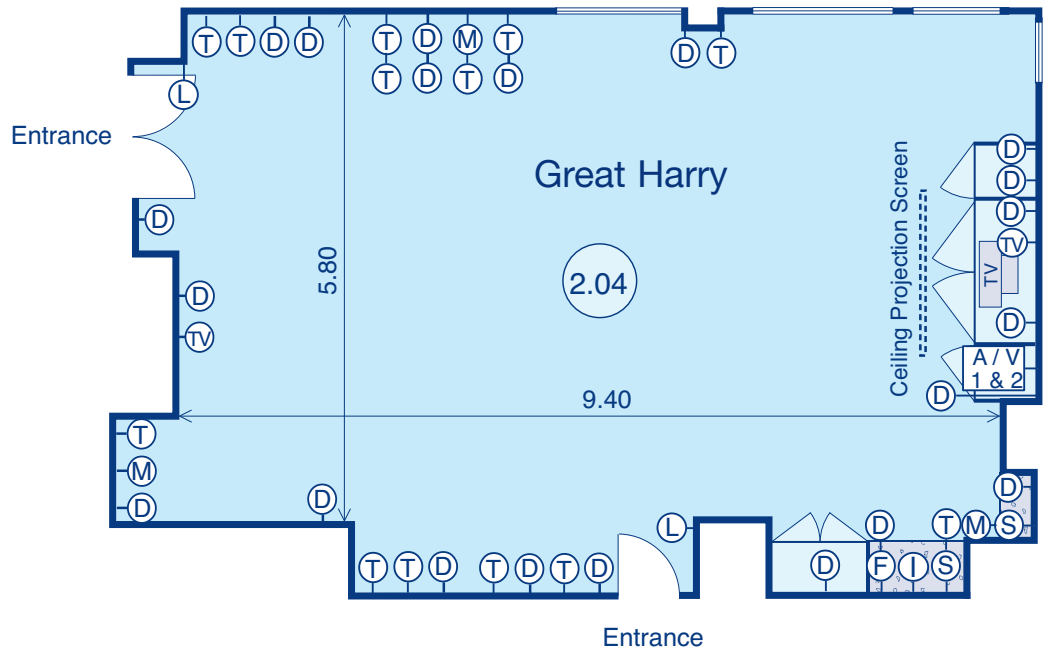

[back to 12th floor floorplan menu](#)



[back to main floorplan menu](#)

Cutty Sark Suite Specification

Floor of hotel	12th
Air Conditioning	yes
CAPACITIES	
Theatre	14
Classroom	-
Boardroom	8
Hollow Square	-
U-shape	-
Cabaret	-
Reception	-
Dinner - rounds	8
Dinner dance	-
BASIC DIMENSIONS	
Length	- metres 5.76
	- feet 18'11"
Width	- metres 3.53
	- feet 11'7"
Height	- metres 2.07
	- feet 6'9"
Area	- metres 20.00
	- feet 215
ACCESS	
Door height	- metres 1.95
	- feet 6'4"
Door width	- metres 0.72
	- feet 2'4"

Key to Symbols

- (D)** Double 13 amp socket
- (S)** Single 13 amp socket
- (TV)** TV Aerial point
- (T)** Telephone socket
- (F)** Fax/Modem socket
- (I)** ISDN2 socket
- (M)** Microphone socket
- (L)** Light switch
- (Sp)** Speaker socket
- (Dx)** 5 pin DMX socket
- (Va)** 15 pin VGA socket
- (X)** 19 pin lighting connector
- (⊗)** 16amp single phase supply
- (⊙)** 32amp single phase supply
-  Serving Surface
- (0.00)** Ceiling Height

Cutty Sark Suite Floorplan

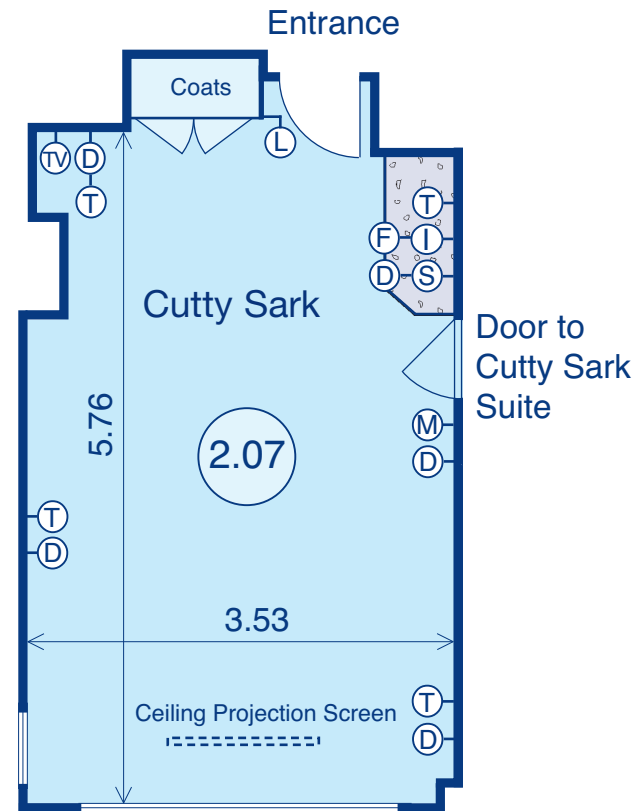

back to 12th floor
floorplan menu



back to main
floorplan menu

Tyger Suite Specification

Floor of hotel	12th
Air Conditioning	yes
CAPACITIES	
Theatre	14
Classroom	-
Boardroom	8
Hollow Square	-
U-shape	-
Cabaret	-
Reception	-
Dinner - rounds	8
Dinner dance	-
BASIC DIMENSIONS	
Length	- metres 5.96
	- feet 19'7"
Width	- metres 3.52
	- feet 11'7"
Height	- metres 2.07
	- feet 6'9"
Area	- metres 21.00
	- feet 226
ACCESS	
Door height	- metres 1.95
	- feet 6'4"
Door width	- metres 0.72
	- feet 2'4"

Key to Symbols

- (D)** Double 13 amp socket
- (S)** Single 13 amp socket
- (TV)** TV Aerial point
- (T)** Telephone socket
- (F)** Fax/Modem socket
- (I)** ISDN2 socket
- (M)** Microphone socket
- (L)** Light switch
- (Sp)** Speaker socket
- (Dx)** 5 pin DMX socket
- (Va)** 15 pin VGA socket
- (X)** 19 pin lighting connector
- (⊗)** 16amp single phase supply
- (⊙)** 32amp single phase supply
-  Serving Surface
- (0.00)** Ceiling Height

Tyger Suite Floorplan

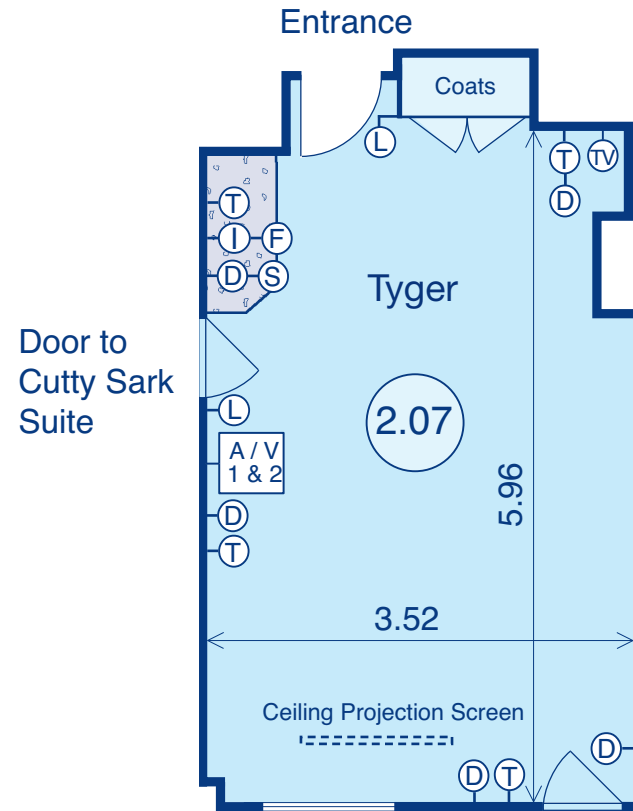

[back to 12th floor floorplan menu](#)

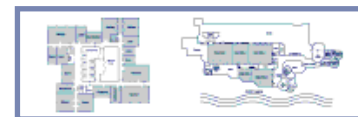

[back to main floorplan menu](#)

Great Eastern Suite Specification

Floor of hotel	12th
Air Conditioning	yes
CAPACITIES	
Theatre	20
Classroom	12
Boardroom	15
Hollow Square	-
U-shape	-
Cabaret	-
Reception	-
Dinner - rounds	16
Dinner dance	-
BASIC DIMENSIONS	
Length	- metres 7.35
	- feet 24'1"
Width	- metres 3.96
	- feet 13'0"
Height	- metres 2.22
	- feet 7'3"
Area	- metres 29.00
	- feet 312
ACCESS	
Door height	- metres 1.95
	- feet 6'4"
Door width	- metres 0.72
	- feet 2'4"

Key to Symbols

- (D)** Double 13 amp socket
- (S)** Single 13 amp socket
- (TV)** TV Aerial point
- (T)** Telephone socket
- (F)** Fax/Modem socket
- (I)** ISDN2 socket
- (M)** Microphone socket
- (L)** Light switch
- (Sp)** Speaker socket
- (Dx)** 5 pin DMX socket
- (Va)** 15 pin VGA socket
- (X)** 19 pin lighting connector
- (⊗)** 16amp single phase supply
- (⊙)** 32amp single phase supply
-  Serving Surface
- (0.00)** Ceiling Height

Great Eastern Suite Floorplan

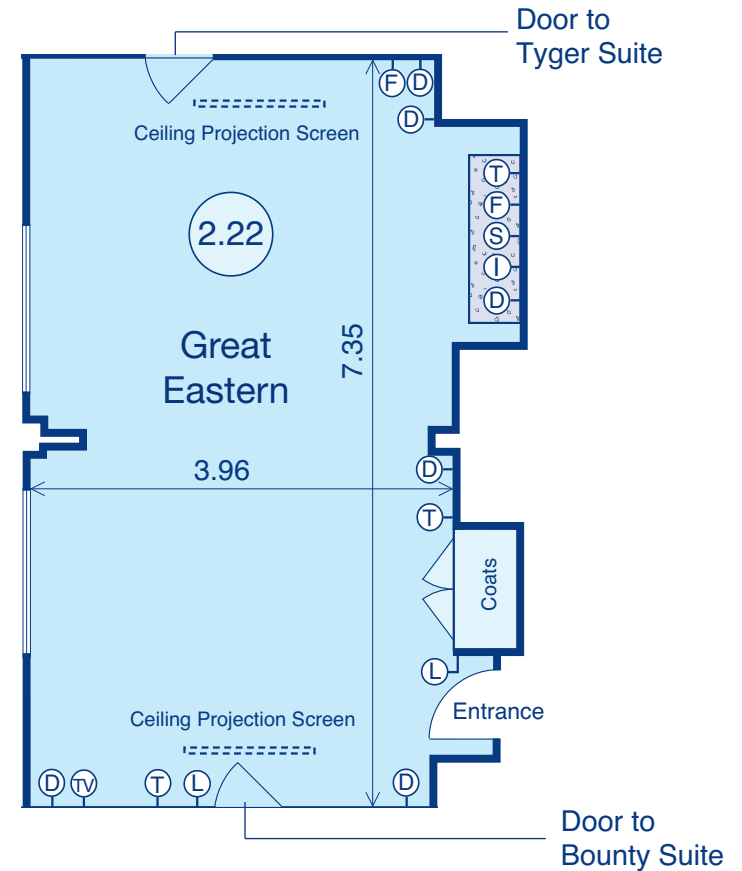

back to 12th floor
floorplan menu



back to main
floorplan menu

Bounty Suite Specification

Floor of hotel	12th
Air Conditioning	yes
CAPACITIES	
Theatre	15
Classroom	-
Boardroom	8
Hollow Square	-
U-shape	-
Cabaret	-
Reception	-
Dinner - rounds	8
Dinner dance	-
BASIC DIMENSIONS	
Length	- metres 5.72
	- feet 18'8"
Width	- metres 3.52
	- feet 11'7"
Height	- metres 2.08
	- feet 6'10"
Area	- metres 20.00
	- feet 215
ACCESS	
Door height	- metres 1.95
	- feet 6'4"
Door width	- metres 0.72
	- feet 2'4"

Key to Symbols

- Double 13 amp socket
- Single 13 amp socket
- TV Aerial point
- Telephone socket
- Fax/Modem socket
- ISDN2 socket
- Microphone socket
- Light switch
- Speaker socket
- 5 pin DMX socket
- 15 pin VGA socket
- 19 pin lighting connector
- 16amp single phase supply
- 32amp single phase supply
- Serving Surface
- Ceiling Height

Bounty Suite Floorplan

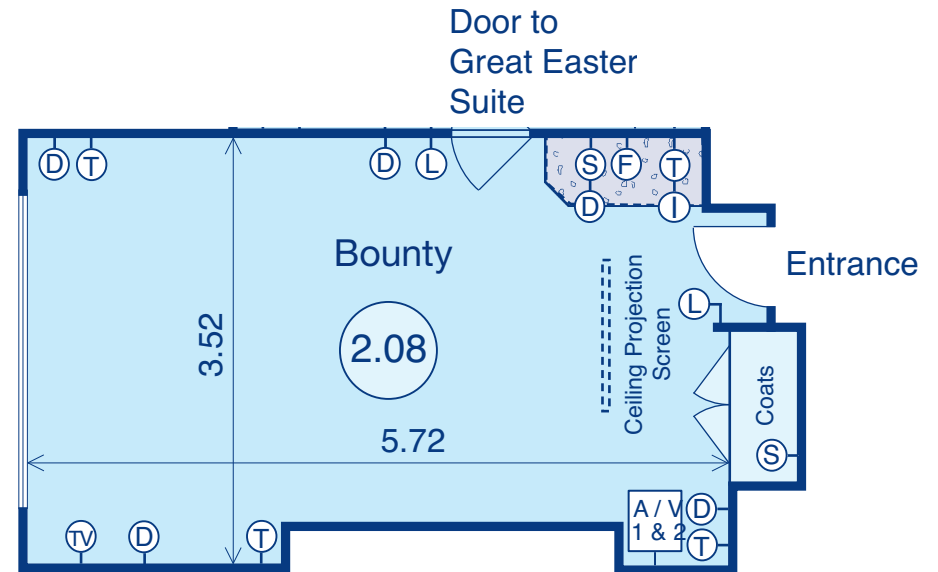

back to 12th floor
floorplan menu



















back to main
floorplan menu

Belfast Suite Specification

Floor of hotel	12th	
Air Conditioning	yes	
CAPACITIES		
Theatre	16	
Classroom	-	
Boardroom	10	
Hollow Square	-	
U-shape	-	
Cabaret	-	
Reception	-	
Dinner - rounds	-	
Dinner dance	-	
BASIC DIMENSIONS		
Length	- metres	5.74
	- feet	18'10"
Width	- metres	3.91
	- feet	12'10"
Height	- metres	2.08
	- feet	6'10"
Area	- metres	22.50
	- feet	242
ACCESS		
Door height	- metres	1.95
	- feet	6'4"
Door width	- metres	0.72
	- feet	2'4"

Key to Symbols

-  Double 13 amp socket
-  Single 13 amp socket
-  TV Aerial point
-  Telephone socket
-  Fax/Modem socket
-  ISDN2 socket
-  Microphone socket
-  Light switch
-  Speaker socket
-  5 pin DMX socket
-  15 pin VGA socket
-  19 pin lighting connector
-  16amp single phase supply
-  32amp single phase supply
-  Serving Surface
-  0.00 Ceiling Height

Belfast Suite Floorplan

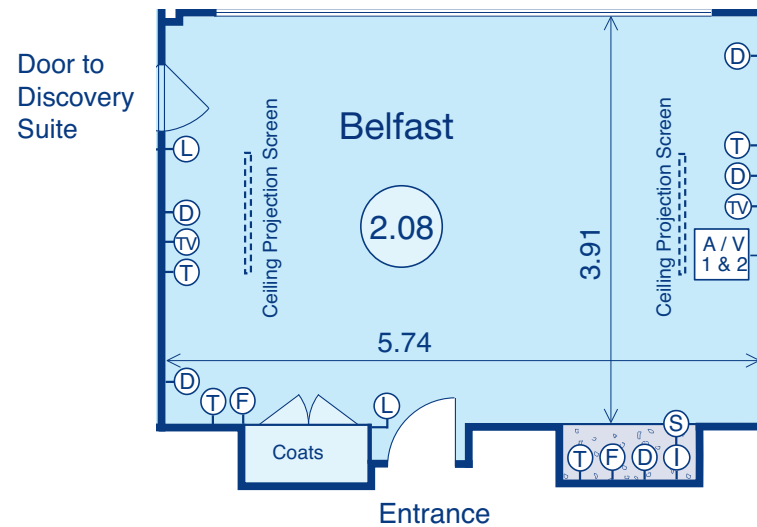

back to 12th floor
floorplan menu



back to main
floorplan menu

Endeavour Suite Specification

Floor of hotel	12th
Air Conditioning	yes
CAPACITIES	
Theatre	-
Classroom	-
Boardroom	8
Hollow Square	-
U-shape	-
Cabaret	-
Reception	-
Dinner - rounds	-
Dinner dance	-
BASIC DIMENSIONS	
Length	- metres 5.68
	- feet 18'8"
Width	- metres 3.52
	- feet 11'7"
Height	- metres 2.07
	- feet 6'9"
Area	- metres 19.99
	- feet 214
ACCESS	
Door height	- metres 1.95
	- feet 6'4"
Door width	- metres 0.72
	- feet 2'4"

Key to Symbols

- (D)** Double 13 amp socket
- (S)** Single 13 amp socket
- (TV)** TV Aerial point
- (T)** Telephone socket
- (F)** Fax/Modem socket
- (I)** ISDN2 socket
- (M)** Microphone socket
- (L)** Light switch
- (Sp)** Speaker socket
- (Dx)** 5 pin DMX socket
- (Va)** 15 pin VGA socket
- (X)** 19 pin lighting connector
- (⊗)** 16amp single phase supply
- (⊙)** 32amp single phase supply
-  Serving Surface
- (0.00)** Ceiling Height

Endeavour Suite Floorplan

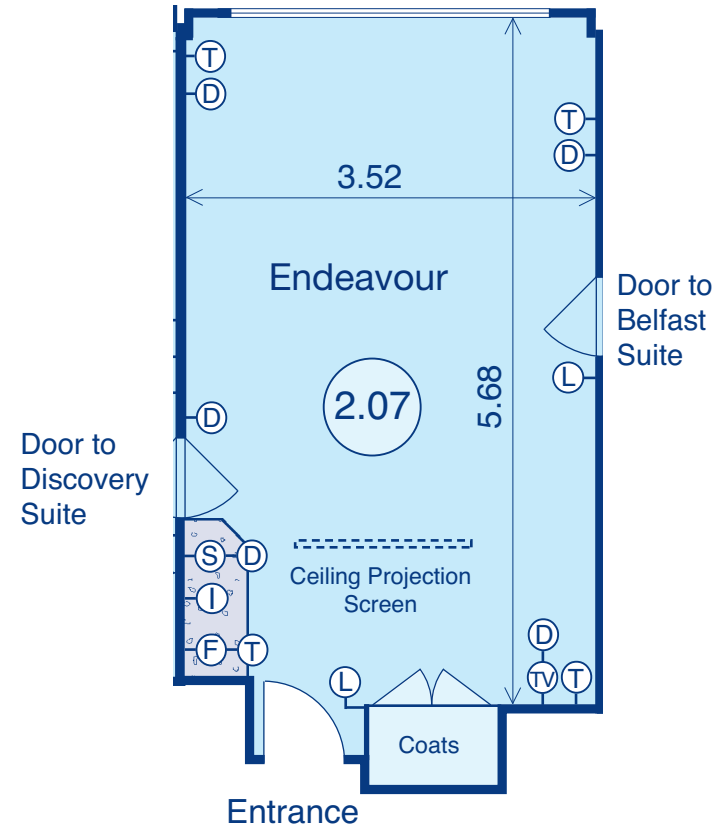

[back to 12th floor floorplan menu](#)



[back to main floorplan menu](#)



Discovery Suite Specification

Floor of hotel	12th
Air Conditioning	yes
CAPACITIES	
Theatre	45
Classroom	30
Boardroom	28
Hollow Square	-
U-shape	28
Cabaret	-
Reception	-
Dinner - rounds	40
Dinner dance	-
BASIC DIMENSIONS	
Length	- metres 10.38
	- feet 34'0"
Width	- metres 5.59
	- feet 18'4"
Height	- metres 2.06
	- feet 6'9"
Area	- metres 58.00
	- feet 624
ACCESS	
Door height	- metres 1.95
	- feet 6'4"
Door width	- metres 0.72
	- feet 2'4"

Key to Symbols

- (D)** Double 13 amp socket
- (S)** Single 13 amp socket
- (TV)** TV Aerial point
- (T)** Telephone socket
- (F)** Fax/Modem socket
- (I)** ISDN2 socket
- (M)** Microphone socket
- (L)** Light switch
- (Sp)** Speaker socket
- (Dx)** 5 pin DMX socket
- (Va)** 15 pin VGA socket
- (X)** 19 pin lighting connector
- (⊗)** 16amp single phase supply
- (⊙)** 32amp single phase supply
-  Serving Surface
- (0.00)** Ceiling Height

Discovery Suite Floorplan

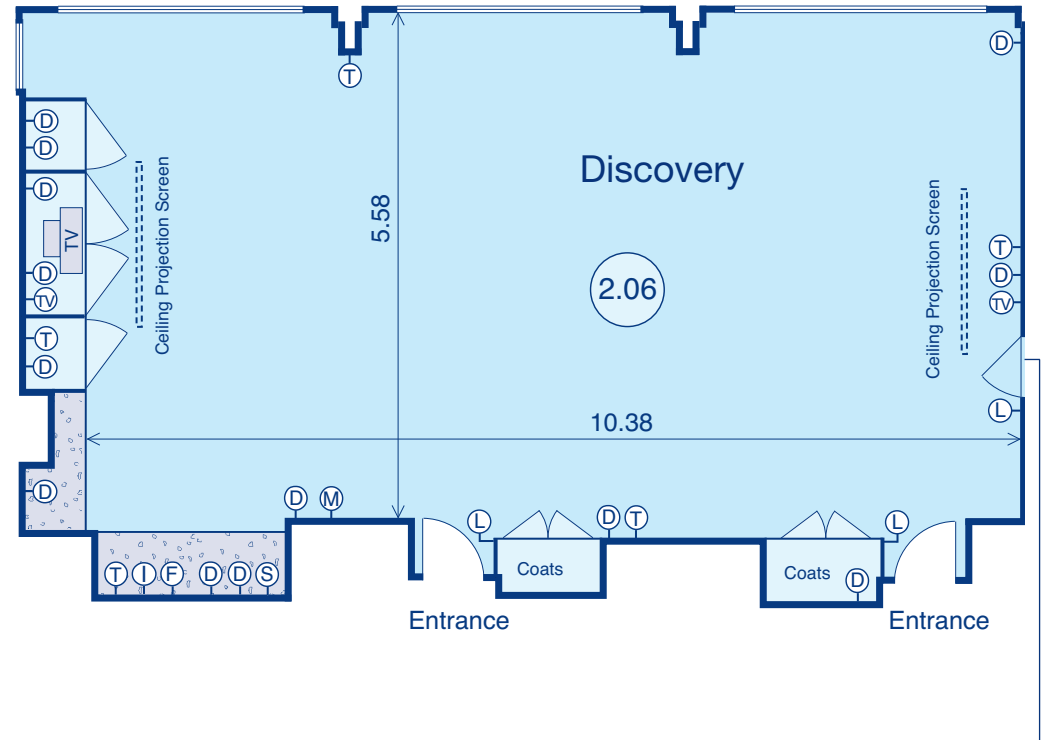

back to 12th floor floorplan menu



back to main floorplan menu

Door to Endeavour Suite

Resolution Suite Specification

Floor of hotel	12th
Air Conditioning	yes
CAPACITIES	
Theatre	16
Classroom	-
Boardroom	10
Hollow Square	-
U-shape	-
Cabaret	-
Reception	-
Dinner - rounds	-
Dinner dance	-
BASIC DIMENSIONS	
Length	- metres 5.90
	- feet 19'4"
Width	- metres 4.05
	- feet 13'3"
Height	- metres 2.05
	- feet 6'8"
Area	- metres 24.00
	- feet 258
ACCESS	
Door height	- metres 1.95
	- feet 6'4"
Door width	- metres 0.72
	- feet 2'4"

Key to Symbols

- Double 13 amp socket
- Single 13 amp socket
- TV Aerial point
- Telephone socket
- Fax/Modem socket
- ISDN2 socket
- Microphone socket
- Light switch
- Speaker socket
- 5 pin DMX socket
- 15 pin VGA socket
- 19 pin lighting connector
- 16amp single phase supply
- 32amp single phase supply
- Serving Surface
- Ceiling Height

Resolution Suite Floorplan

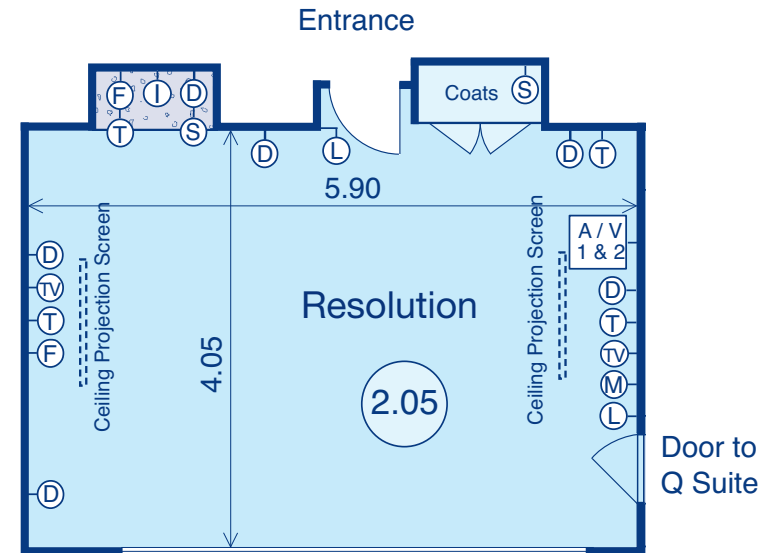

back to 12th floor
floorplan menu



















back to main
floorplan menu

Q Suite Specification

Floor of hotel	12th
Air Conditioning	yes
CAPACITIES	
Theatre	-
Classroom	-
Boardroom	8
Hollow Square	-
U-shape	-
Cabaret	-
Reception	-
Dinner - rounds	8
Dinner dance	-
BASIC DIMENSIONS	
Length	- metres 5.90
	- feet 19'4"
Width	- metres 3.60
	- feet 11'10"
Height	- metres 2.06
	- feet 6'9"
Area	- metres 21.00
	- feet 226
ACCESS	
Door height	- metres 1.95
	- feet 6'4"
Door width	- metres 0.72
	- feet 2'4"

Key to Symbols

-  Double 13 amp socket
-  Single 13 amp socket
-  TV Aerial point
-  Telephone socket
-  Fax/Modem socket
-  ISDN2 socket
-  Microphone socket
-  Light switch
-  Speaker socket
-  5 pin DMX socket
-  15 pin VGA socket
-  19 pin lighting connector
-  16amp single phase supply
-  32amp single phase supply
-  Serving Surface
-  Ceiling Height

Q Suite Floorplan

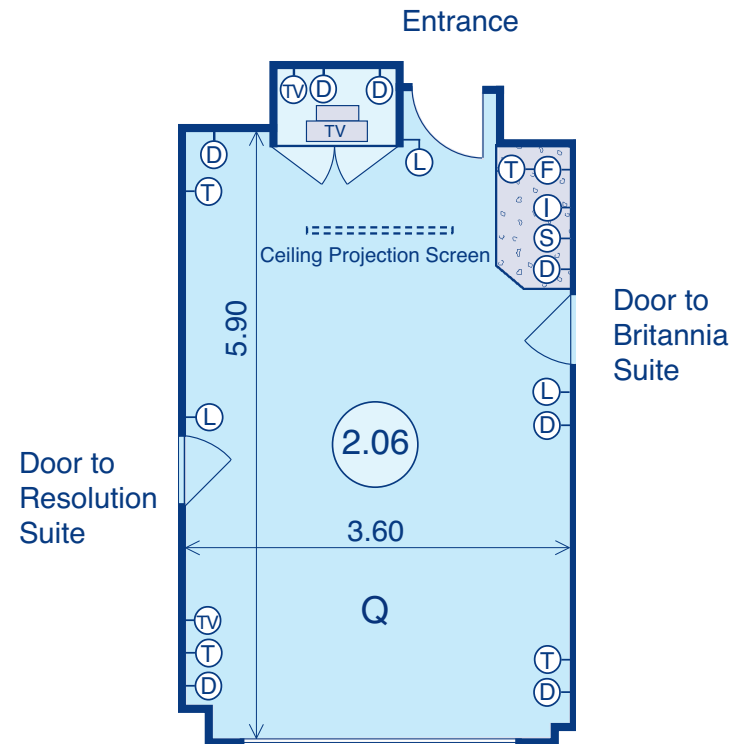

[back to 12th floor floorplan menu](#)



[back to main floorplan menu](#)

Britannia Suite Specification

Floor of hotel	12th
Air Conditioning	yes
CAPACITIES	
Theatre	45
Classroom	30
Boardroom	28
Hollow Square	-
U-shape	28
Cabaret	-
Reception	-
Dinner - rounds	40
Dinner dance	-
BASIC DIMENSIONS	
Length	- metres 11.25
	- feet 37'
Width	- metres 5.65
	- feet 18'6"
Height	- metres 2.06
	- feet 6'9"
Area	- metres 63.50
	- feet 683
ACCESS	
Door height	- metres 1.95
	- feet 6'4"
Door width	- metres 0.72
	- feet 2'4"

Key to Symbols

- (D)** Double 13 amp socket
- (S)** Single 13 amp socket
- (TV)** TV Aerial point
- (T)** Telephone socket
- (F)** Fax/Modem socket
- (I)** ISDN2 socket
- (M)** Microphone socket
- (L)** Light switch
- (Sp)** Speaker socket
- (Dx)** 5 pin DMX socket
- (Va)** 15 pin VGA socket
- (X)** 19 pin lighting connector
- (⊗)** 16amp single phase supply
- (⊙)** 32amp single phase supply
-  Serving Surface
- (0.00)** Ceiling Height

Britannia Suite Floorplan

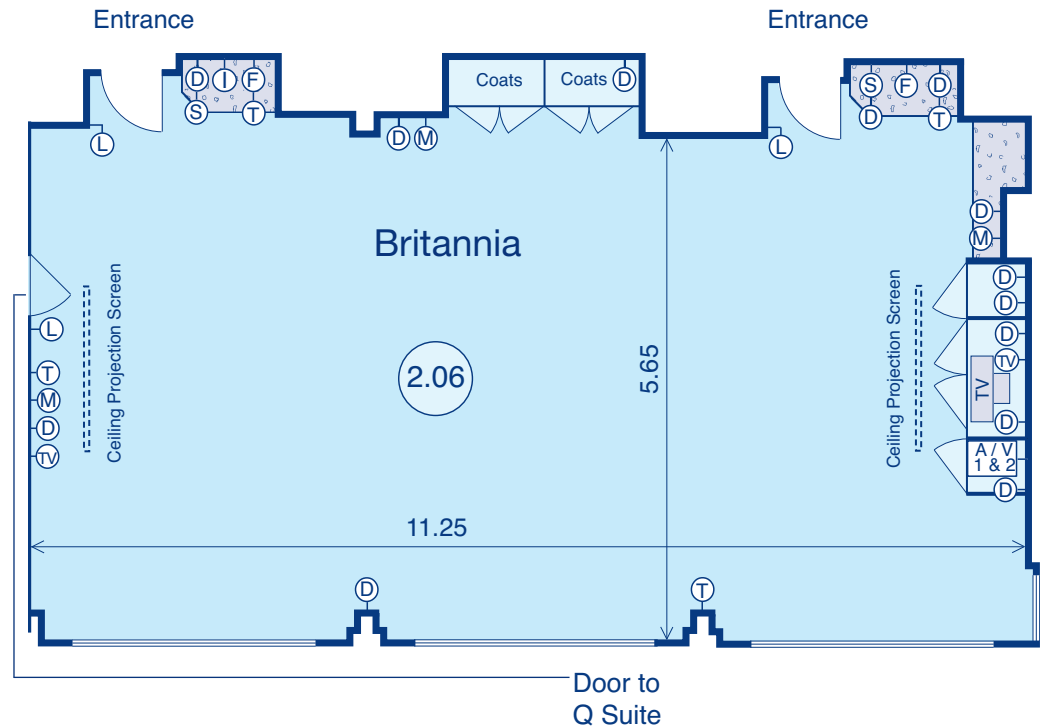

[back to 12th floor floorplan menu](#)

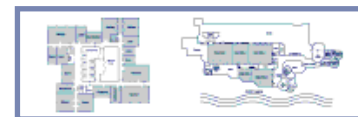

















[back to main floorplan menu](#)

Mayflower Suite Specification

Floor of hotel	12th	
Air Conditioning	yes	
CAPACITIES		
Theatre	30	
Classroom	18	
Boardroom	14	
Hollow Square	-	
U-shape	14	
Cabaret	-	
Reception	-	
Dinner - rounds	16	
Dinner dance	-	
BASIC DIMENSIONS		
Length	- metres	6.16
	- feet	20'3"
Width	- metres	5.95
	- feet	19'6"
Height	- metres	2.06
	- feet	6'9"
Area	- metres	36.50
	- feet	393
ACCESS		
Door height	- metres	1.95
	- feet	6'4"
Door width	- metres	1.40
	- feet	4'8"

Key to Symbols

-  Double 13 amp socket
-  Single 13 amp socket
-  TV Aerial point
-  Telephone socket
-  Fax/Modem socket
-  ISDN2 socket
-  Microphone socket
-  Light switch
-  Speaker socket
-  5 pin DMX socket
-  15 pin VGA socket
-  19 pin lighting connector
-  16amp single phase supply
-  32amp single phase supply
-  Serving Surface
-  Ceiling Height

Mayflower Suite Floorplan

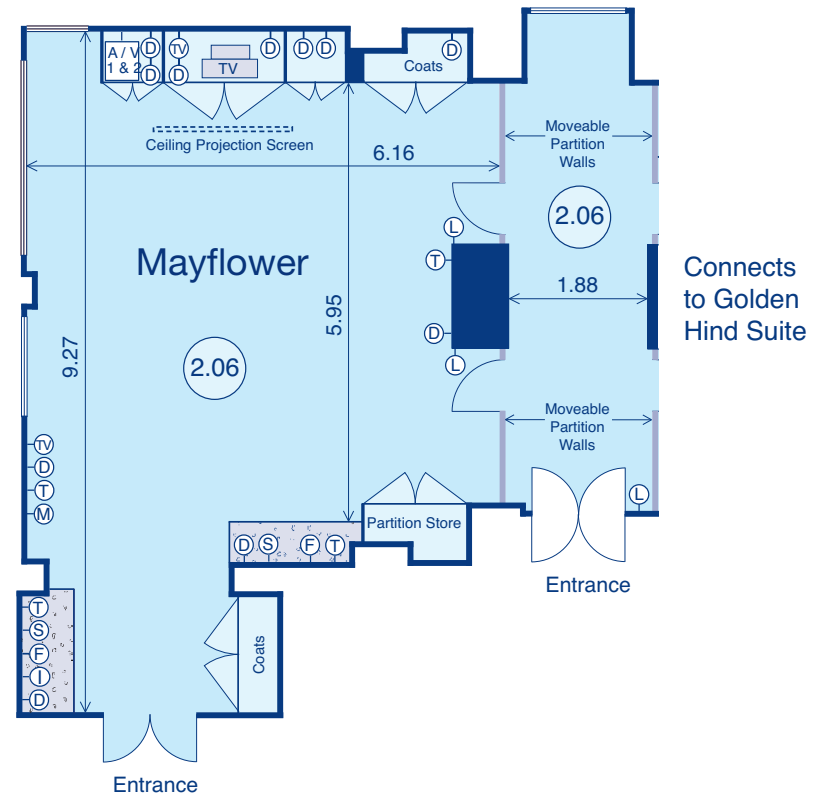

back to 12th floor
floorplan menu



back to main
floorplan menu



Golden Hind Suite Specification

Golden Hind Suite Floorplan

Floor of hotel	12th
Air Conditioning	yes
CAPACITIES	
Theatre	30
Classroom	18
Boardroom	14
Hollow Square	-
U-shape	14
Cabaret	-
Reception	-
Dinner - rounds	16
Dinner dance	-
BASIC DIMENSIONS	
Length	- metres 6.17
	- feet 20'3"
Width	- metres 5.95
	- feet 19'6"
Height	- metres 2.06
	- feet 6'9"
Area	- metres 36.50
	- feet 393
ACCESS	
Door height	- metres 1.95
	- feet 6'4"
Door width	- metres 1.40
	- feet 4'8"

Key to Symbols

- (D)** Double 13 amp socket
- (S)** Single 13 amp socket
- (TV)** TV Aerial point
- (T)** Telephone socket
- (F)** Fax/Modem socket
- (I)** ISDN2 socket
- (M)** Microphone socket
- (L)** Light switch
- (Sp)** Speaker socket
- (Dx)** 5 pin DMX socket
- (Va)** 15 pin VGA socket
- (X)** 19 pin lighting connector
- (⊗)** 16amp single phase supply
- (⊙)** 32amp single phase supply
-  Serving Surface
- (0.00)** Ceiling Height

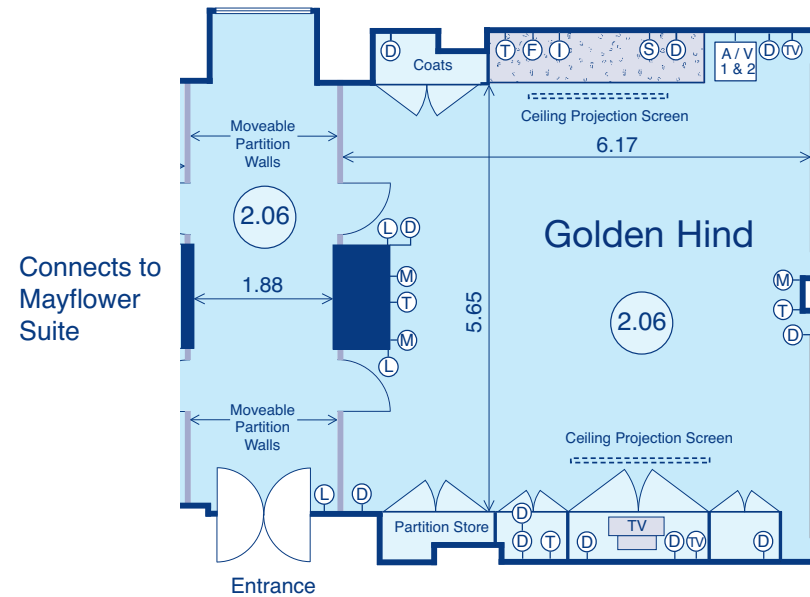

back to 12th floor floorplan menu

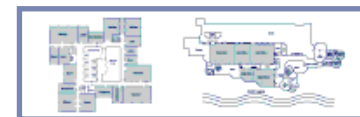

back to main floorplan menu



Tower Suite

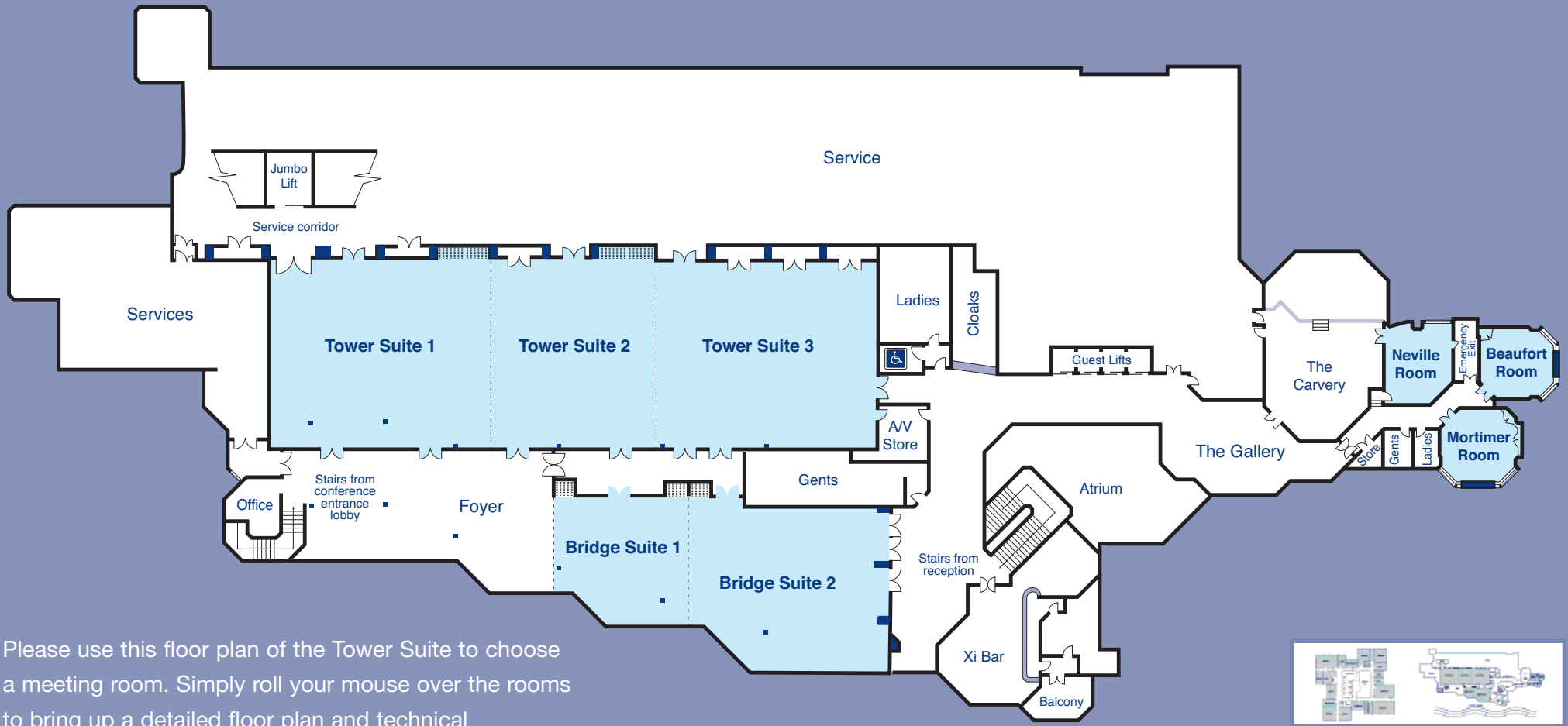

Please use this floor plan of the Tower Suite to choose a meeting room. Simply roll your mouse over the rooms to bring up a detailed floor plan and technical specification of that room.



















[back to main floorplan menu](#)

Neville Suite Specification

Floor of hotel	upper foyer	
Air Conditioning	yes	
CAPACITIES		
Theatre	50	
Classroom	40	
Boardroom	18	
Hollow Square	-	
U-shape	20	
Cabaret	-	
Reception	-	
Dinner - rounds	50	
Dinner dance	-	
BASIC DIMENSIONS		
Length	- metres	7.88
	- feet	25'10"
Width	- metres	7.70
	- feet	26'3"
Height	- metres	2.06
	- feet	6'9"
Area	- metres	61
	- feet	656
ACCESS		
Door height	- metres	1.98
	- feet	6'6"
Door width	- metres	0.99
	- feet	5'0"

Key to Symbols

-  Double 13 amp socket
-  Single 13 amp socket
-  TV Aerial point
-  Telephone socket
-  Fax/Modem socket
-  ISDN2 socket
-  Microphone socket
-  Light switch
-  Speaker socket
-  5 pin DMX socket
-  15 pin VGA socket
-  19 pin lighting connector
-  16amp single phase supply
-  32amp single phase supply
-  Serving Surface
-  Ceiling Height

Neville Suite Floorplan

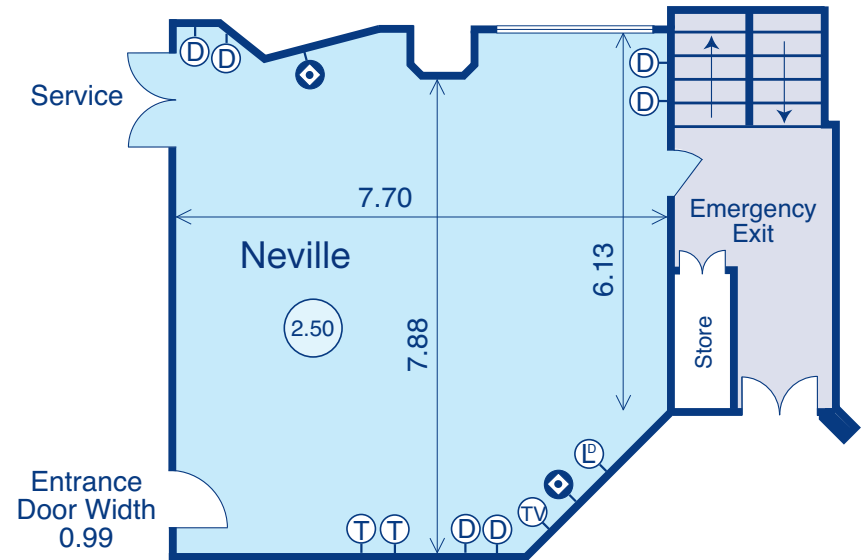

[back to tower suite floorplan menu](#)



















[back to main floorplan menu](#)

Beaufort Suite Specification

Floor of hotel	upper foyer	
Air Conditioning	yes	
CAPACITIES		
Theatre	30	
Classroom	20	
Boardroom	14	
Hollow Square	-	
U-shape	22	
Cabaret	-	
Reception	-	
Dinner - rounds	30	
Dinner dance	-	
BASIC DIMENSIONS		
Length	- metres	7.05
	- feet	23'2"
Width	- metres	6.05
	- feet	19'10"
Height	- metres	2.06
	- feet	6'9"
Area	- metres	42
	- feet	452
ACCESS		
Door height	- metres	1.98
	- feet	6'6"
Door width	- metres	1.52
	- feet	5'0"

Key to Symbols

-  Double 13 amp socket
-  Single 13 amp socket
-  TV Aerial point
-  Telephone socket
-  Fax/Modem socket
-  ISDN2 socket
-  Microphone socket
-  Light switch
-  Speaker socket
-  5 pin DMX socket
-  15 pin VGA socket
-  19 pin lighting connector
-  16amp single phase supply
-  32amp single phase supply
-  Serving Surface
-  Ceiling Height

Beaufort Suite Floorplan

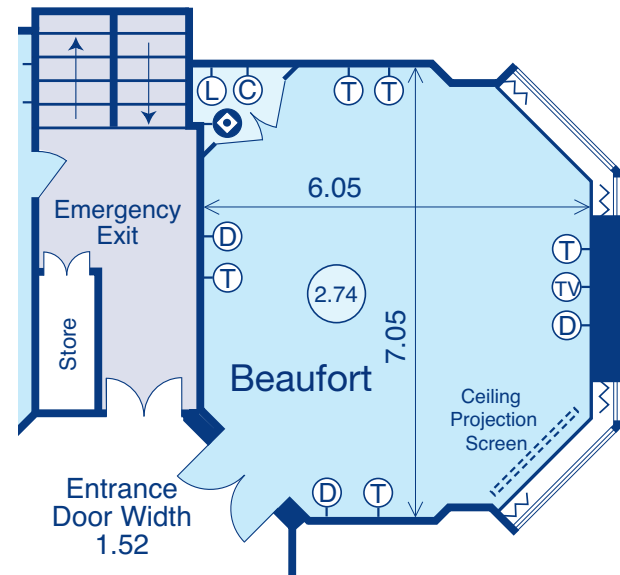

[back to tower suite floorplan menu](#)



















[back to main floorplan menu](#)

Mortimer Suite Specification

Floor of hotel	upper foyer	
Air Conditioning	yes	
CAPACITIES		
Theatre	35	
Classroom	28	
Boardroom	16	
Hollow Square	-	
U-shape	24	
Cabaret	-	
Reception	-	
Dinner - rounds	40	
Dinner dance	-	
BASIC DIMENSIONS		
Length	- metres	7.24
	- feet	23'9"
Width	- metres	6.55
	- feet	21'6"
Height	- metres	2.04
	- feet	6'8"
Area	- metres	47
	- feet	506
ACCESS		
Door height	- metres	1.98
	- feet	6'6"
Door width	- metres	1.52
	- feet	5'0"

Key to Symbols

-  Double 13 amp socket
-  Single 13 amp socket
-  TV Aerial point
-  Telephone socket
-  Fax/Modem socket
-  ISDN2 socket
-  Microphone socket
-  Light switch
-  Speaker socket
-  5 pin DMX socket
-  15 pin VGA socket
-  19 pin lighting connector
-  16amp single phase supply
-  32amp single phase supply
-  Serving Surface
-  Ceiling Height

Mortimer Suite Floorplan

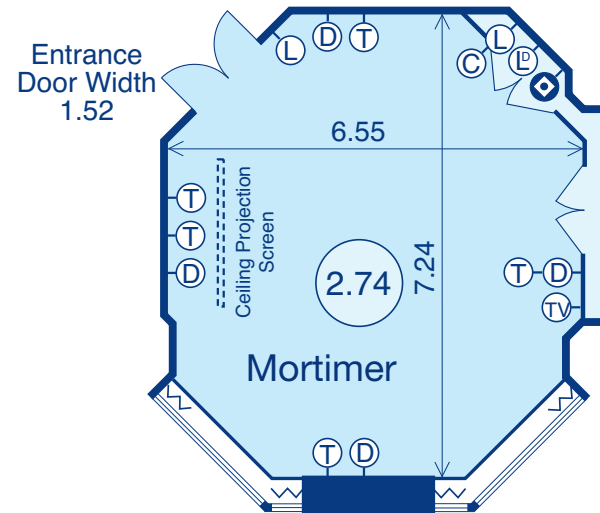

[back to tower suite floorplan menu](#)



[back to main floorplan menu](#)



Tower Suite Combined Floorplan

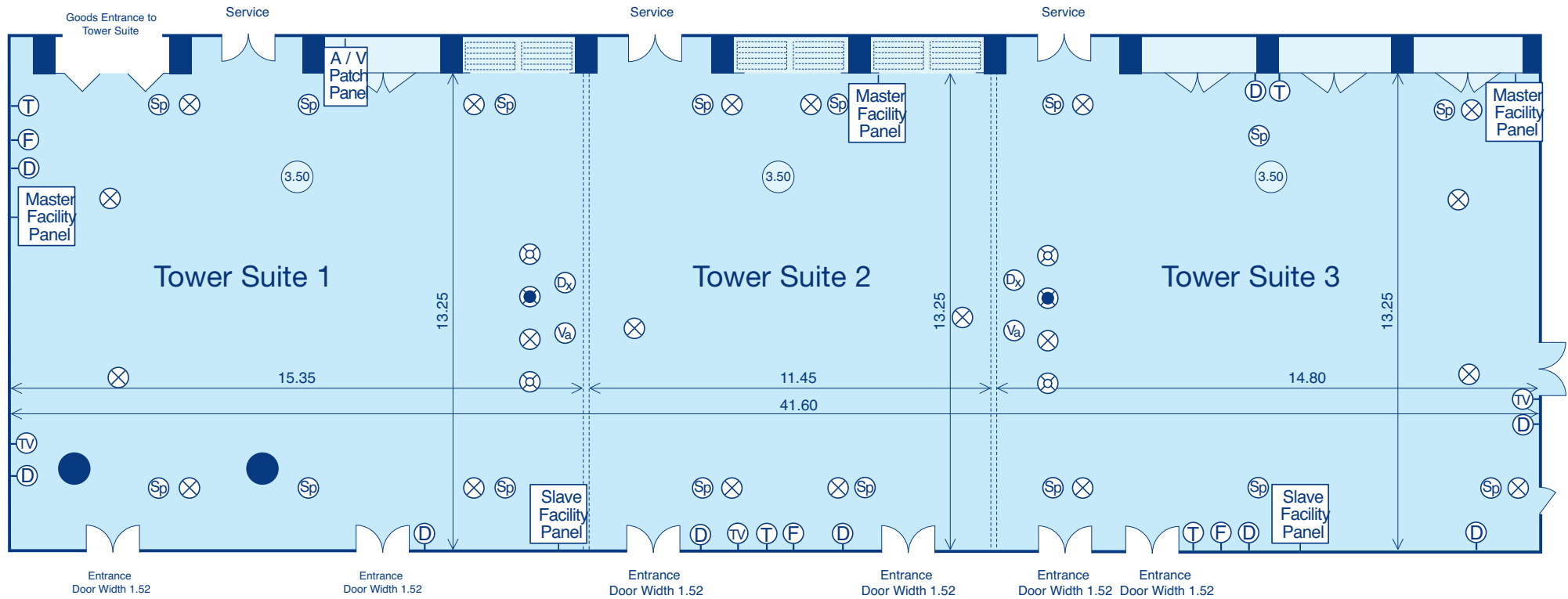

[back to tower suite floorplan menu](#)



[back to main floorplan menu](#)

Tower Suite One Specification

Floor of hotel	upper foyer		
Air Conditioning	yes		
CAPACITIES	Suite 1	Suite 1,2 & 3	
Theatre	210	600	
Classroom	120	350	
Boardroom	-	-	
Hollow Square	-	-	
U-shape	-	-	
Cabaret	120	320	
Reception	200	600	
Dinner - rounds	150	500	
Dinner dance	100	450	
BASIC DIMENSIONS			
Length	- metres	15.35	41.60
	- feet	50'4"	136'6"
Width	- metres	13.25	13.25
	- feet	43'6"	43'6"
Height	- metres	3.50	3.50
	- feet	11'6"	11'6"
Area	- metres	203	222
	- feet	2184	2382
ACCESS			
Door height	- metres	1.98	1.98
	- feet	6'6"	6'6"
Door width	- metres	1.52	1.52
	- feet	5'0"	5'0"

Key to Symbols

- (D)** Double 13 amp socket
- (S)** Single 13 amp socket
- (TV)** TV Aerial point
- (T)** Telephone socket
- (F)** Fax/Modem socket
- (I)** ISDN2 socket
- (M)** Microphone socket
- (L)** Light switch
- (Sp)** Speaker socket
- (Dx)** 5 pin DMX socket
- (Va)** 15 pin VGA socket
- (X)** 19 pin lighting connector
- (⊗)** 16amp single phase supply
- (●)** 32amp single phase supply
-  Serving Surface
- (0.00)** Ceiling Height

Tower Suite One Floorplan

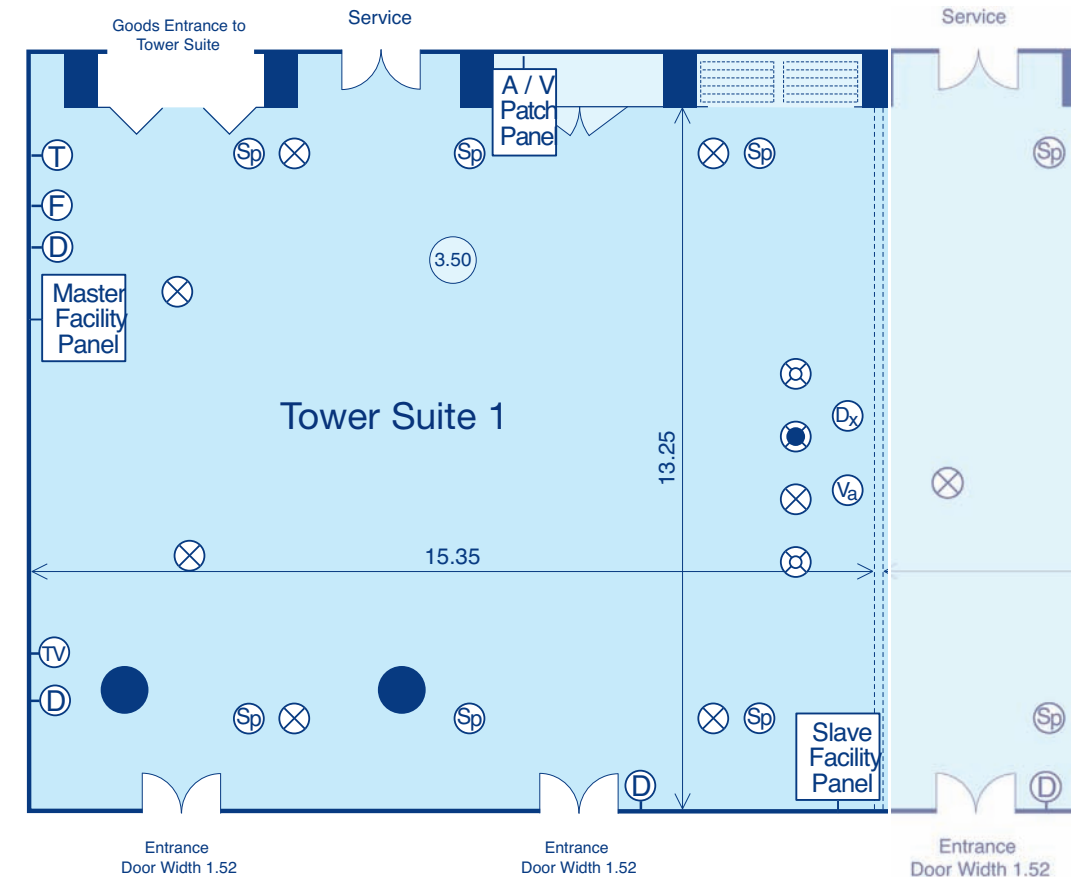

[back to tower suite floorplan menu](#)



[back to main floorplan menu](#)

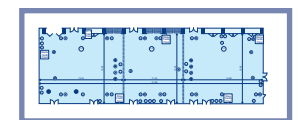

[back to tower suite combined floorplan](#)



Tower Suite Two Specification

Floor of hotel	upper foyer		
Air Conditioning	yes		
CAPACITIES	Suite 2	Suite 1,2 & 3	
Theatre	180	600	
Classroom	84	350	
Boardroom	-	-	
Hollow Square	-	-	
U-shape	-	-	
Cabaret	72	320	
Reception	150	600	
Dinner - rounds	110	500	
Dinner dance	80	450	
BASIC DIMENSIONS			
Length	- metres	11.45	41.60
	- feet	37'7"	136'6"
Width	- metres	13.25	13.25
	- feet	43'6"	43'6"
Height	- metres	3.50	3.50
	- feet	11'6"	11'6"
Area	- metres	152	551
	- feet	1635	5928
ACCESS			
Door height	- metres	1.98	1.98
	- feet	6'6"	6'6"
Door width	- metres	1.52	1.52
	- feet	5'0"	5'0"

Key to Symbols

- (D)** Double 13 amp socket
- (S)** Single 13 amp socket
- (TV)** TV Aerial point
- (T)** Telephone socket
- (F)** Fax/Modem socket
- (I)** ISDN2 socket
- (M)** Microphone socket
- (L)** Light switch
- (Sp)** Speaker socket
- (Dx)** 5 pin DMX socket
- (Va)** 15 pin VGA socket
- (X)** 19 pin lighting connector
- (X)** 16amp single phase supply
- (X)** 32amp single phase supply
-  Serving Surface
- (0.00)** Ceiling Height

Tower Suite Two Floorplan

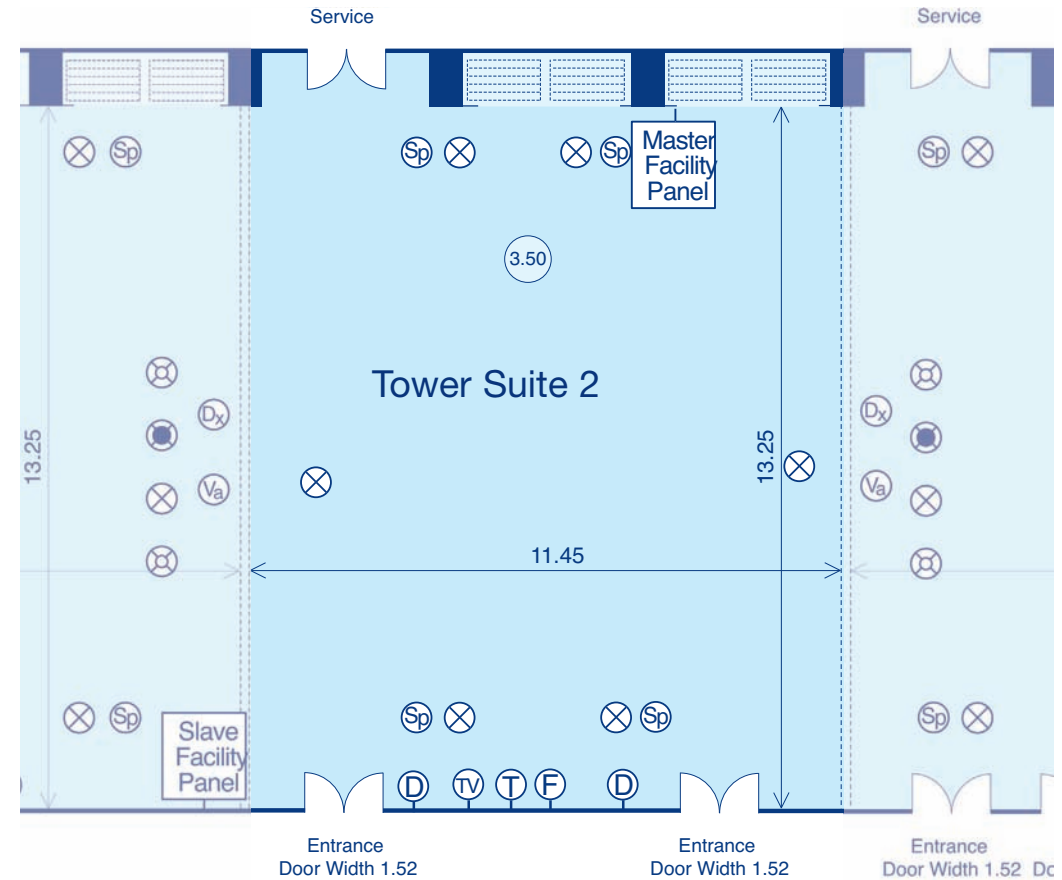

[back to tower suite floorplan menu](#)



[back to main floorplan menu](#)

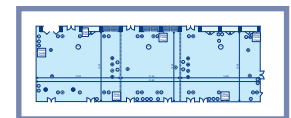

[back to tower suite combined floorplan](#)



Tower Suite Three Specification

Floor of hotel	upper foyer		
Air Conditioning	yes		
CAPACITIES	Suite 3	Suite 1,2 & 3	
Theatre	210	600	
Classroom	140	350	
Boardroom	-	-	
Hollow Square	-	-	
U-shape	-	-	
Cabaret	120	320	
Reception	200	600	
Dinner - rounds	150	500	
Dinner dance	100	450	
BASIC DIMENSIONS			
Length	- metres	14.80	41.60
	- feet	48'7"	136'6"
Width	- metres	13.25	13.25
	- feet	43'6"	43'6"
Height	- metres	3.50	3.50
	- feet	11'6"	11'6"
Area	- metres	196	551
	- feet	2109	5928
ACCESS			
Door height	- metres	1.98	1.98
	- feet	6'6"	6'6"
Door width	- metres	1.52	1.52
	- feet	5'0"	5'0"

Key to Symbols

- (D)** Double 13 amp socket
- (S)** Single 13 amp socket
- (TV)** TV Aerial point
- (T)** Telephone socket
- (F)** Fax/Modem socket
- (I)** ISDN2 socket
- (M)** Microphone socket
- (L)** Light switch
- (Sp)** Speaker socket
- (Dx)** 5 pin DMX socket
- (Va)** 15 pin VGA socket
- (X)** 19 pin lighting connector
- (⊗)** 16amp single phase supply
- (⊙)** 32amp single phase supply
-  Serving Surface
- (0.00)** Ceiling Height

Tower Suite Three Floorplan

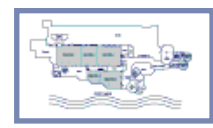
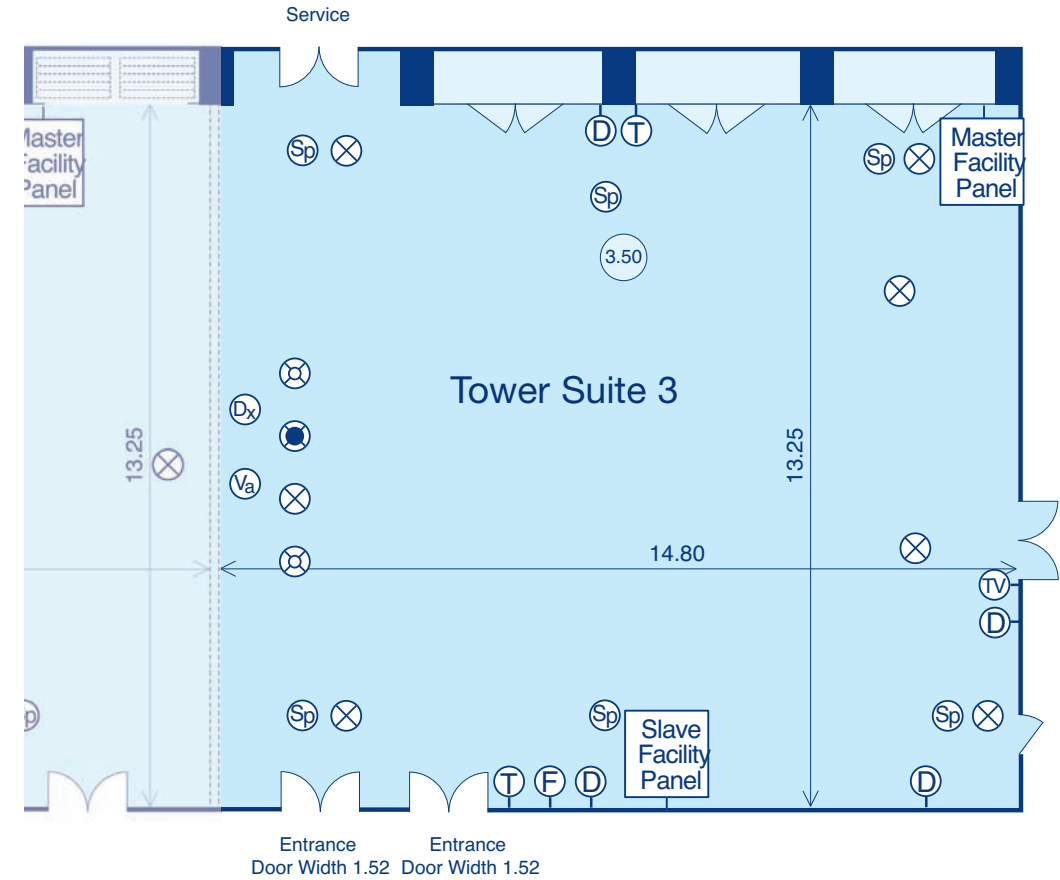

[back to tower suite floorplan menu](#)



[back to main floorplan menu](#)

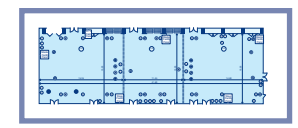

[back to tower suite combined floorplan](#)



Bridge Suite Combined Floorplan

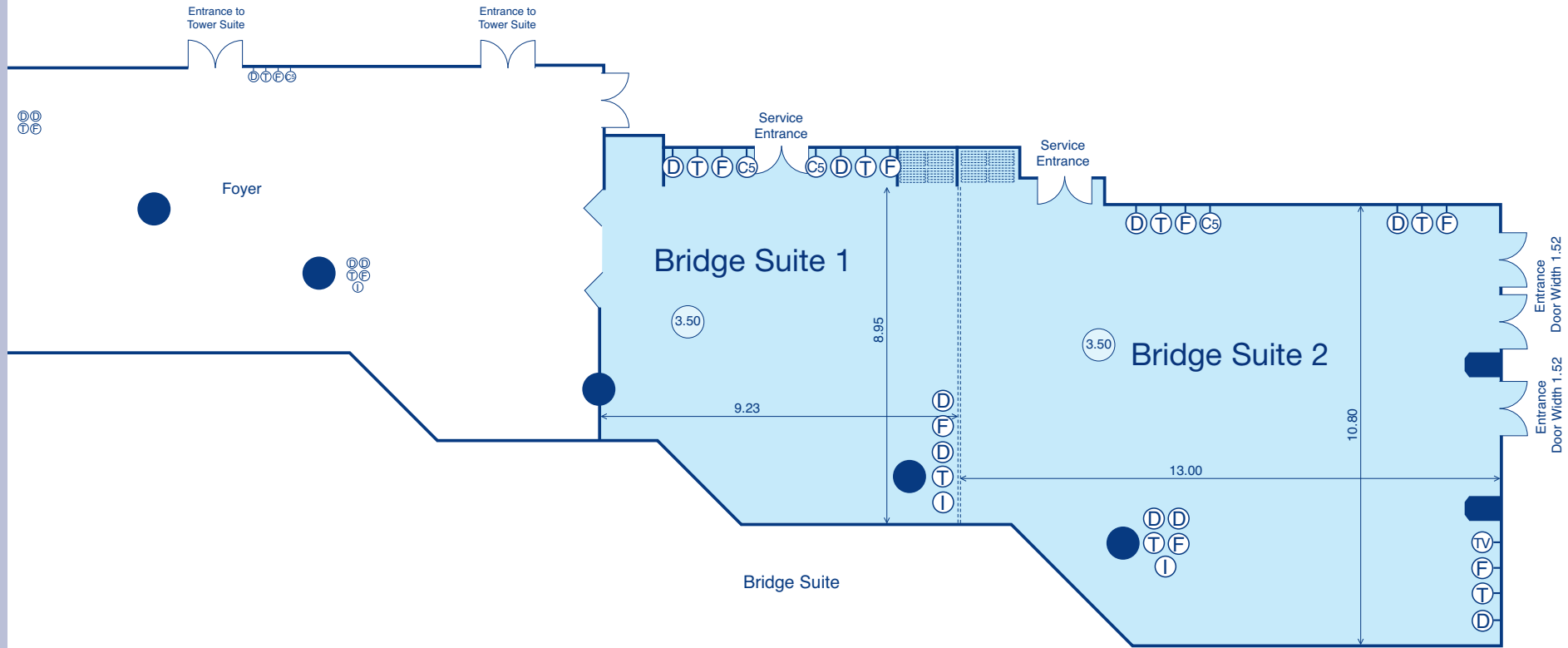

[back to tower suite floorplan menu](#)



[back to main floorplan menu](#)

Bridge Suite One Specification

Floor of hotel	upper foyer		
Air Conditioning	yes		
CAPACITIES	Suite 1	Suite 1&2	
Theatre	60	210	
Classroom	40	-	
Boardroom	25	-	
Hollow Square	-	-	
U-shape	-	-	
Cabaret	35	-	
Reception	60	-	
Dinner - rounds	120	250	
Dinner dance	100	170	
BASIC DIMENSIONS			
Length	- metres	9.23	22.23
	- feet	30'3"	72'11"
Width	- metres	8.95	-
	- feet	29'4"	-
Height	- metres	3.50	3.50
	- feet	11'6"	11'6"
Area	- metres	82	222
	- feet	882	2388
ACCESS			
Door height	- metres	1.98	1.98
	- feet	6'6"	6'6"
Door width	- metres	1.52	1.52
	- feet	5'0"	5'0"

Key to Symbols

- (D)** Double 13 amp socket
- (S)** Single 13 amp socket
- (TV)** TV Aerial point
- (T)** Telephone socket
- (F)** Fax/Modem socket
- (I)** ISDN2 socket
- (M)** Microphone socket
- (L)** Light switch
- (Sp)** Speaker socket
- (Dx)** 5 pin DMX socket
- (Va)** 15 pin VGA socket
- (X)** 19 pin lighting connector
- (⊗)** 16amp single phase supply
- (⊙)** 32amp single phase supply
-  Serving Surface
- (0.00)** Ceiling Height

Bridge Suite One Floorplan

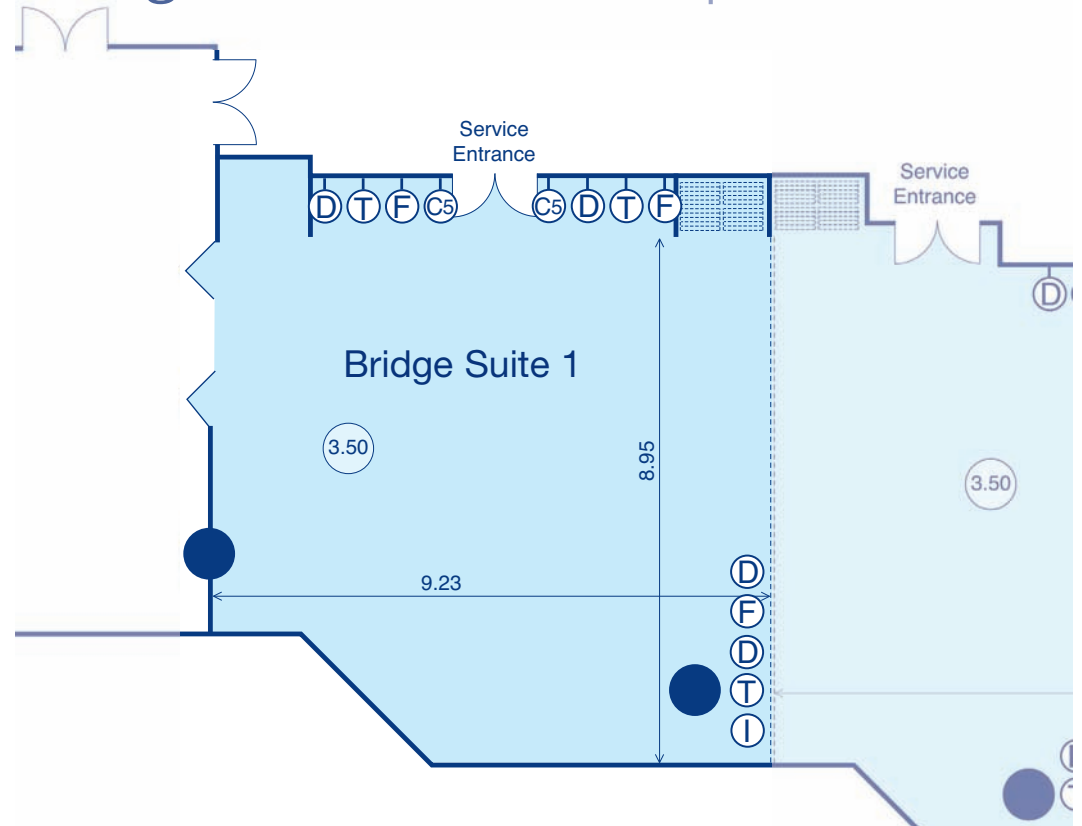

back to tower suite floorplan menu



back to main floorplan menu

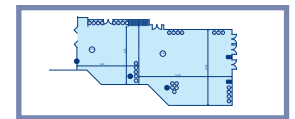

back to bridge suite combined floorplan

Bridge Suite Two Specification

Floor of hotel	upper foyer		
Air Conditioning	yes		
CAPACITIES	Suite 2	Suite 1&2	
Theatre	120	210	
Classroom	60	-	
Boardroom	40	-	
Hollow Square	-	-	
U-shape	-	-	
Cabaret	63	56	
Reception	140	-	
Dinner - rounds	80	120	
Dinner dance	-	100	
BASIC DIMENSIONS			
Length	- metres	13.00	22.23
	- feet	42'8"	72'11"
Width	- metres	10.80	-
	- feet	35'5"	-
Height	- metres	3.50	3.50
	- feet	11'6"	11'6"
Area	- metres	140	222
	- feet	1506	2388
ACCESS			
Door height	- metres	1.98	1.98
	- feet	6'6"	6'6"
Door width	- metres	1.52	1.52
	- feet	5'0"	5'0"

Key to Symbols

- (D)** Double 13 amp socket
- (S)** Single 13 amp socket
- (TV)** TV Aerial point
- (T)** Telephone socket
- (F)** Fax/Modem socket
- (I)** ISDN2 socket
- (M)** Microphone socket
- (L)** Light switch
- (Sp)** Speaker socket
- (Dx)** 5 pin DMX socket
- (Va)** 15 pin VGA socket
- (X)** 19 pin lighting connector
- (⊗)** 16amp single phase supply
- (⊙)** 32amp single phase supply
-  Serving Surface
- (0.00)** Ceiling Height

Bridge Suite Two Floorplan

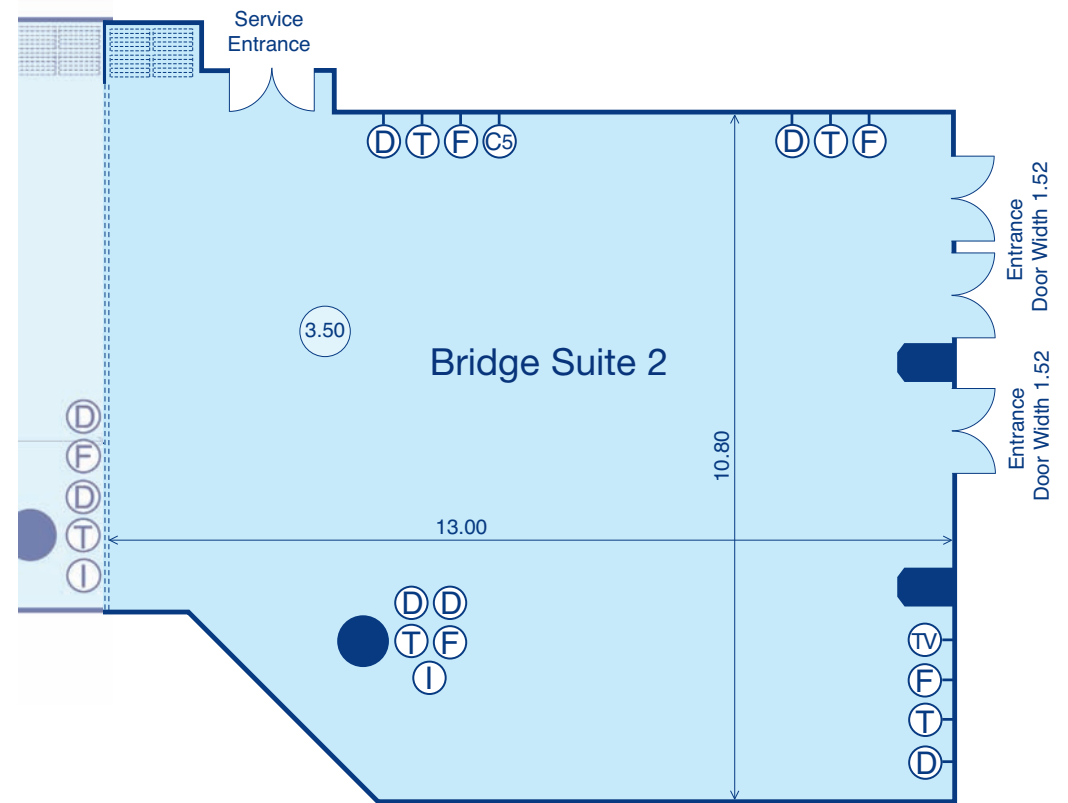

[back to tower suite floorplan menu](#)



[back to main floorplan menu](#)

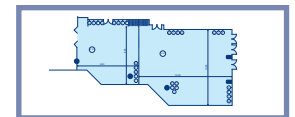

[back to bridge suite combined floorplan](#)

A feast for the senses.

People work best when they feel well looked after. Specifically, when they get enough to eat and drink through the day. Create has the flexibility to offer a choice of dining, either in one of our restaurants, in your meeting room or even having a separate room to dine in, be it for a formal or working lunch, whether it's for 550 or four people.



Traditional English Fayre, serving delicious roast meats, light lunches, salads and desserts in a delightful setting overlooking St Katharine's Dock.



the gallery

For a more intimate break out for coffee, lunch or a drink, the Gallery offers a wide choice, set against a backdrop of the Thames, Butler's Wharf and Tower Bridge.

next >

print - quit

THE BRASSERIE AT THE TOWER HOTEL

For superb dining and sumptuous, mouthwatering cuisine, all prepared to order, The Brasserie chefs are as international as our cuisine.

The hardest choice you'll have to make won't be which dish will tempt your palate the most, but which view you'd prefer to dine against. Tower Bridge, The Tower of London or boats moored in St Katharine's Dock are just some of the views to be enjoyed whilst you dine. A true feast for all the senses.



With stunning views of the Thames and Tower Bridge, this is the perfect place to relax, unwind and enjoy a drink.



The Brasserie



The Carvery

create for you

introduction - facilities - why choose create - floor plans - additional services - contact

Offering you more.

If your event runs into a second or third day, The Tower offers all the comfort and convenience you need. Everything about The Tower has been carefully considered to make it the ideal venue for both business and pleasure.

Bedrooms that offer the perfect fusion of form and function, splicing style and comfort with technology and convenience. Bars and restaurants, with everything from a quick coffee and Danish to a leisurely lunch or sumptuous evening meal. A fitness centre for those who like to exercise both the body as well as the mind.

And any time you need a fresh perspective, the best of London is right on the doorstep. The City and West End, are within easy reach as are all the main transport links in and out of town.

Make your next event an occasion to remember – in a venue you'll never forget.



Xi Bar



The Lobby



A City Club Room

< previous

print - quit

www.guoman.com



Directions.

Rail

In close proximity to Waterloo, Liverpool Street, Fenchurch Street and London Bridge.

Underground

Take the Circle & District Lines to Tower Hill or the DLR to Tower Gateway.

Air

London City, London Stansted and London Heathrow

Road

The Tower is situated just outside the Congestion Charge Zone

For more information about Create and the special room rates available at The Tower for delegates and guests, please contact our dedicated sales team on **0871 376 9036**, or email **tower@guoman.com** or visit the website: **www.guoman.com**